

DETAIL OF CONSTRUCTION



MINNESOTA
ILLINOIS
MICHIGAN
COLORADO

MICHIGAN OFFICE
WOLD ARCHITECTS AND ENGINEERS
202 E. THIRD STREET, SUITE 200
ROYAL OAK, MICHIGAN 48067
TEL: 248.284.0611
FAX: 248.284.0615

AFF Above Finish Floor
AP Access Panel
ACT Acoustic Ceiling Tile
ADJ Adjustable
AGG Aggregate
ALT Alternate
ALUM Aluminum
ANCH Anchor
AB Anchor Bolt
APPROX Approximate
ARCH Architect(ural)
AV Audio Visual
ACOUST Acoustical

BLKG Blocking
BSMT Basement
BRG Bearing
BM Beam
BM Bench Mark
BTWN Between
BLK Block
BLK C Block Course
BD Board
BOT Bottom
BFE Bottom Footing Elevation
BRKT Bracket
BR Brick
BR C Brick Course
BR L Brick Ledge
BLDG Building
B BD Bulletin Board
B BLK Burnished Concrete Block

CAB Cabinet
CO2 Carbon Dioxide
CPT Carpet
CI Cast Iron
CIP Cast Iron Pipe
CB Catch Basin
CLG Ceiling
CEM Cement
CSWK Casework
CL Center Line
C to C Center to Center
CT Ceramic Tile

C BD Chalk Board
CIRC Circuit or Circumference
CO Cleanout
CLOS Closet
CR Cold Rolled
CONC Concrete
C BLK Concrete Block
CONST Construction
CONTR Contractor
CJ Control Joint
CONT Continuous
CONV Convactor
CG Corner Guard
CORR Corrugated or Corridor
CMP Corrugated Metal Pipe
CSK Countersink
CS Course
CU Cubic
CFM Cubic Foot (Feet) Per Minute

DPG Dampproofing
DEPT Department
DET Detail
DIA Diameter
DIM Dimension
DISP Dispenser
DIST Distribution
DO Ditto
DR Door
DWLS Dowels
DN Down
DS Downspout
DWG Drawing
DF Drinking Fountain
DIP Ductile Iron Pipe
DKG Decking

EA Each
EIFS Exterior Insulation Finish System
EF Each Face or Exhaust Fan
EW Each Way
E East
EL Elevation (Vertical Dimension)
ELEC Electric(al)

SUBJECT: REDFORD UNION BECK ELEMENTARY RENOVATIONS

DATE: 5/6/10

COMMISSION NO: 094023

REVISIONS

REV. DATE

11001

DETAIL OF CONSTRUCTION



MINNESOTA
ILLINOIS
MICHIGAN
COLORADO

MICHIGAN OFFICE
WOLD ARCHITECTS AND ENGINEERS
202 E. THIRD STREET, SUITE 200
ROYAL OAK, MICHIGAN 48067
TEL: 248.284.0611
FAX: 248.284.0615

ENC	Electric Water Cooler	GLU-LAM	Glue Laminated
ELEV	Elevation (Bldg.) Elevator	GB	Grab Bar
ENAM	Enamel	GR	Grade
ENT	Entrance	GRV	Gravity Roof Ventilator
EQ	Equal	GYP BD	Gypsum Board
EGUIP	Equipment		
ETC	Et Cetera	HD	Hand Dryer
EX	Existing	HCAP	Handicapped
EXH	Exhaust	HR	Handrail
EXIST	Existing	HS	Handset
EJ	Expansion Joint	HDBD	Hardboard
EXP	Exposed	H	Hardener
EXT	Exterior	HDW	Hardware
		HDWD	Hardwood
FLRG	Flooring	HT	Height
FB	Face Brick	HP	High Point
FIN	Finish	HM	Hollow Metal
FE	Fire Extinguisher	HORIZ	Horizontal
FR	Fire Rated	HC	Hose Cabinet
FIXT	Fixture	HR	Hour
FHS	Flat Head Screw	HYD	Hydrant
FD	Floor Drain		
FFAS	Floor Finish As Scheduled	IN	Inch
FL	Floor or Float	I	Inside Diameter
FT	Foot or Feet	IF	Inside Face
FTG	Footing	INSUL	Insulation
FDN	Foundation	INT	Interior
FR	Frame	INV	Invert
FA	Fresh Air		
FS	Full Size	JAN	Janitor
FURR	Furring	JT	Joint
FRMG	Framing	JST	Joist
GPM	Gallons Per Minute	K PL	Kick Plate
GALV	Galvanized	KD	Knock Down
GI	Galvanized Iron	KP	Knock Out
G	Gas		
GA	Gauge	LAB	Laboratory
GEN	General	LAM	Laminated
GC	General Contractor	LAV	Lavatory
GL	Glass or Glazing	LH	Left Hand
GL BLK	Glass Block	LOC	Locate
G BLK	Glazed Concrete Block	LLH	Long Leg Horizontal
GST	Glazed Structural Tile		

SUBJECT: REDFORD UNION BECK ELEMENTARY RENOVATIONS

DATE: 5/6/10

COMMISSION NO: 094023

REVISIONS

REV. DATE

11002

DETAIL OF CONSTRUCTION



MINNESOTA
ILLINOIS
MICHIGAN
COLORADO

MICHIGAN OFFICE
WOLD ARCHITECTS AND ENGINEERS
202 E. THIRD STREET, SUITE 200
ROYAL OAK, MICHIGAN 48067
TEL: 248.284.0611
FAX: 248.284.0615

<p>LLV Long Leg Vertical LP Low Point LB Pound LWCB Lightweight Concrete Block</p> <p>M BD Marker Board MACH Machine MH Manhole MFR Manufacturer MAS Masonry MO Masonry Opening MATL Material MAX Maximum MECH Mechanical MED CAB Medicine Cabinet MEMB Membrane MET Metal MEZZ Mezzanine MIN Minimum MIR Mirror M/S Mirror & Shelf MISC Miscellaneous MM Miscellaneous Metal MLDG Moulding MTG Mounting MUL Mullion</p> <p>NOM Nominal N North NIC Not in Contract NTS Not to Scale NO Number</p> <p>OBS Obscure OC On Center OPG Opening OPP Opposite OZ Ounce OD Outside Diameter OF Outside Face OA Overall OH Overhead OHM Overhead Motorized</p>	<p>PT(D) Paint(ed) PNL Panel or Paneling PTD Paper Towel Dispenser PTD/R Paper Towel Dispenser & Receptor PART Partition P BD Peg Board PERF Perforated PLAS Plaster P LAM Plastic Laminate PL Plate PL GL Plate Glass PLBG Plumbing PLYW'D Plywood POL Polished P. TILE Porcelain Tile PORT C Portland Cement PRV Power Roof Ventilator PROJ Projection PROP Property PROT Protective PC Putty Coat PVMT Pavement</p> <p>QT Quarry Tile</p> <p>RAD Radiation, Radiator REIN CONC Reinforced Concrete RWL Rain Water Leader REC Recessed REV Reverse(d) RDWD Redwood REF Refrigerator REINF Reinforced(ing) REQD Required RES Resilient RA Return Air RH Right Hand R Riser or Radius RD Roof Drain RV Roof Vent RM Room RO Rough Opening RUB Rubber RT Rubber Tile or Tread RS Rough Slab</p>	<p>PT(D) Paint(ed) PNL Panel or Paneling PTD Paper Towel Dispenser PTD/R Paper Towel Dispenser & Receptor PART Partition P BD Peg Board PERF Perforated PLAS Plaster P LAM Plastic Laminate PL Plate PL GL Plate Glass PLBG Plumbing PLYW'D Plywood POL Polished P. TILE Porcelain Tile PORT C Portland Cement PRV Power Roof Ventilator PROJ Projection PROP Property PROT Protective PC Putty Coat PVMT Pavement</p> <p>QT Quarry Tile</p> <p>RAD Radiation, Radiator REIN CONC Reinforced Concrete RWL Rain Water Leader REC Recessed REV Reverse(d) RDWD Redwood REF Refrigerator REINF Reinforced(ing) REQD Required RES Resilient RA Return Air RH Right Hand R Riser or Radius RD Roof Drain RV Roof Vent RM Room RO Rough Opening RUB Rubber RT Rubber Tile or Tread RS Rough Slab</p>
--	--	--

SUBJECT: REDFORD UNION BECK ELEMENTARY RENOVATIONS

DATE: 5/6/10

COMMISSION NO: 094023

REVISIONS

REV. DATE

11003

DETAIL OF CONSTRUCTION



MINNESOTA
ILLINOIS
MICHIGAN
COLORADO

MICHIGAN OFFICE
WOLD ARCHITECTS AND ENGINEERS
202 E. THIRD STREET, SUITE 200
ROYAL OAK, MICHIGAN 48067
TEL: 248.284.0611
FAX: 248.284.0615

RCP	Reflected Ceiling Plan Reinforced Concrete Pipe	TYP	Typical
		TLT PTN	Toilet Partition
SHLVG	Shelving	UNFIN	Unfinished
SND	Sanitary Napkin Dispenser	UH	Unit Heater
SNR	Sanitary Napkin Dispenser Receptor	UV	Unit Ventilator
SF	Sand Float	UNO	Unless Noted Otherwise
SCHED	Schedule	UR	Urinal
SLNT	Sealant	UR SCR	Urinal Screen
SLR	Sealer		
SSRF	Seamless Resilient Floor	VAC	Vacuum
SECT	Section	VENT	Ventilator
SS	Service Sink	VERM	Vermiculite
SH	Sheet	V PLAS	Vermiculite Plaster or Veneer Plaster
SIM	Similar	VERT	Vertical
SOG	Slab on Grade	VEST	Vestibule
SD	Soap Dispenser	VCT	Vinyl Composition Tile
S	South or Sink	VT	Vinyl Tile
SH	Sprinkler Head	VWC	Vinyl Wall Covering
SQ	Square	VTR	Vent Through Roof
S ST	Stainless Steel		
STD	Standard	WSCOT	Wainscot
ST	Steel	WF	Wall Fabric
STOR	Storage	WC	Water Closet
STRUCT	Structural	WH	Water Heater
SA	Supply Air	WP	Waterproofing
SUSP	Suspended	WR	Water Resistant
SW	Switch	WSP	Weatherstrip
SYM	Symmetry or Symmetrical	WH	Weep Hole
		WT	Weight, Wall Tile
T BD	Tack Board	WNF	Welded Wire Fabric
T SP	Tack Strip	W	West or Wire
TEL	Telephone	WR	Wide Flange (Steel) or Wash Fountain
TV	Television	WDW	Window
TEMP	Tempered or Temporary	W	With
TERR	Terrazzo	W/O	Without
TH	Test Hole	WG	Wire Glass
THRES	Threshold	WD	Wood
TPH	Toilet Paper Holder	WI	Wrought Iron
T AND G	Tongue and Groove		
T AND B	Top and Bottom	YD	Yard
TFE	Top of Footing Elevation		
TO MAS	Top of Masonry		
TOS	Top of Steel		
TB	Towel Bar		
T	Tread		
TF	Troweled Finish		

SUBJECT: REDFORD UNION BECK ELEMENTARY RENOVATIONS

DATE: 5/6/10

COMMISSION NO: 094023

REVISIONS

REV. DATE

11004

DETAIL OF CONSTRUCTION



MINNESOTA
ILLINOIS
MICHIGAN
COLORADO

MICHIGAN OFFICE
WOLD ARCHITECTS AND ENGINEERS
202 E. THIRD STREET, SUITE 200
ROYAL OAK, MICHIGAN 48067
TEL: 248.284.0611
FAX: 248.284.0615

∠ Angle
@ at
⊕ Center Line or Center
[Channel
= Equal
Number or Pounds
⌞ Plate
± Plus or Minus
⊙ Round or Diameter
⊞ Square Foot (Feet)
∅ Phase
Δ Delta
Ω Ohm
° Degree

SUBJECT: REDFORD UNION BECK ELEMENTARY RENOVATIONS

DATE: 5/6/10

COMMISSION NO: 094023

REVISIONS



REV. DATE

11005

DETAIL OF CONSTRUCTION



MINNESOTA
ILLINOIS
MICHIGAN
COLORADO

MICHIGAN OFFICE
WOLD ARCHITECTS AND ENGINEERS
202 E. THIRD STREET, SUITE 200
ROYAL OAK, MICHIGAN 48067
TEL: 248.284.0611
FAX: 248.284.0615

DETAIL BOOK
DETAIL REFERENCE



DETAIL NO.
PAGE NO.

ELEVATION



MAJOR WALL &
BLDG. SECTION



REVISIONS



ROOM NUMBER
CEILING HEIGHT



GRIDS



DOOR OR WDW.
SWING & NO.

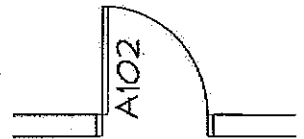

INTERIOR
ELEVATIONS



DETAIL NO.
PAGE NO.

BORROWED
LIGHT

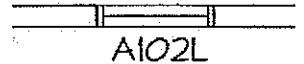

OPENINGS
DEPRESSIONS
OR AS NOTED

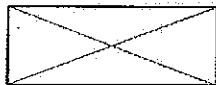

HINGE SIDE

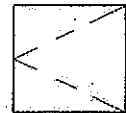

LARGE SHEET
DETAIL REFERENCE



WALL TYPES

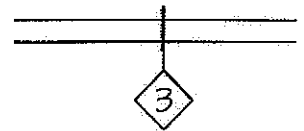

NOTES, DIMENSIONS
& DETAIL KEYS APPLY
FROM NOTED DETAIL

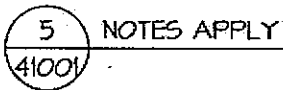

EXTERIOR WINDOWS



STOREFRONT



CURTAINWALL



MARKERBOARDS,
TACKBOARDS,
MAP RAILS



LOUVER



SUBJECT: REDFORD UNION BECK ELEMENTARY RENOVATIONS

DATE: 5/6/10

COMMISSION NO: 094023

REVISIONS

REV. DATE

11006

DETAIL OF CONSTRUCTION



MINNESOTA
ILLINOIS
MICHIGAN
COLORADO

MICHIGAN OFFICE
WOLD ARCHITECTS AND ENGINEERS
202 E. THIRD STREET, SUITE 200
ROYAL OAK, MICHIGAN 48067
TEL: 248.284.0611
FAX: 248.284.0615

EARTH

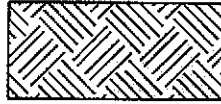

EARTH



ROCK



GRANULAR FILL



SAND

CONCRETE



CONCRETE



TERRAZZO



TOPPING



WIRE MESH

MASONRY



BLOCK

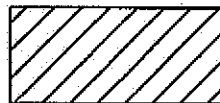

BRICK



CLAY TILE

METAL



FERROUS



ALUMINUM

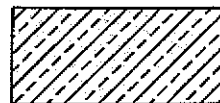

OTHER



SMALL SCALE

WOOD

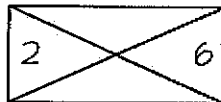

NOMINAL
WITH SIZE

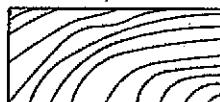

FINISHED

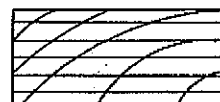

PLYWOOD

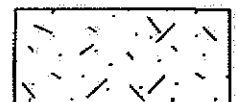

PARTICLE BOARD

STONE



MARBLE

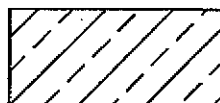

CUT STONE

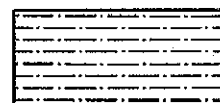

SLATE

INSULATION

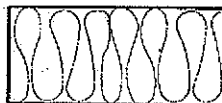

BATT



RIGID

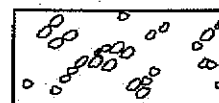

GRANULAR: LOOSE

SUBJECT: REDFORD UNION BECK ELEMENTARY RENOVATIONS

DATE: 5/6/10

COMMISSION NO: 094023

REVISIONS

REV. DATE

11007

DETAIL OF CONSTRUCTION



MINNESOTA
ILLINOIS
MICHIGAN
COLORADO

MICHIGAN OFFICE
WOLD ARCHITECTS AND ENGINEERS
202 E. THIRD STREET, SUITE 200
ROYAL OAK, MICHIGAN 48067
TEL: 248.284.0611
FAX: 248.284.0615

PARTITIONS



METAL STUD



WOOD STUD

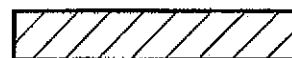

MASONRY

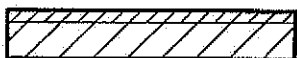

BRICK & BLOCK



CLAY TILE

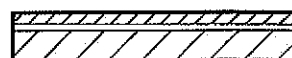

CAVITY WALL



GLAZED OPENING

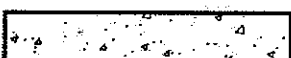

CONCRETE

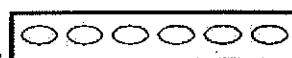

GYPSUM TILE

MISCELLANEOUS

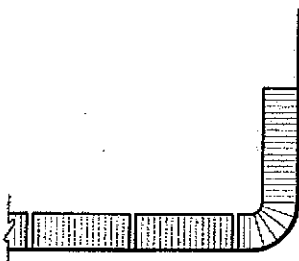

CERAMIC TILE

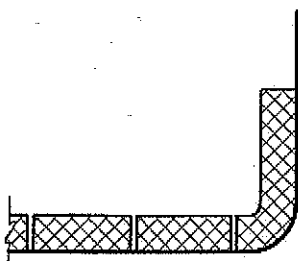

QUARRY TILE



ACOUSTIC TILE



PLASTER



ON METAL
LATH



GYPSUM
TILE



GLASS



PRECAST
CONCRETE

SUBJECT: REDFORD UNION BECK ELEMENTARY RENOVATIONS

DATE: 5/6/10

COMMISSION NO: 094023

REVISIONS



REV. DATE

11008

DETAIL OF CONSTRUCTION



ST. PAUL, MN
 ELGIN, IL
 TROY, MI
 DENVER, CO

ILLINOIS OFFICE
 WOLD ARCHITECTS AND ENGINEERS
 25 SOUTH GROVE AVENUE, SUITE 500
 ELGIN, ILLINOIS 60120
 TEL: 847.608.2600
 FAX: 847.608.2654

PROVIDE 3/4" PAINT GRADE PLYWOOD SIGN.
 SET WITH 2- 4" X 4" FULL HT POSTS. SET IN
 CONCRETE FOOTINGS. COORDINATE LOCATION W/ OWNER.

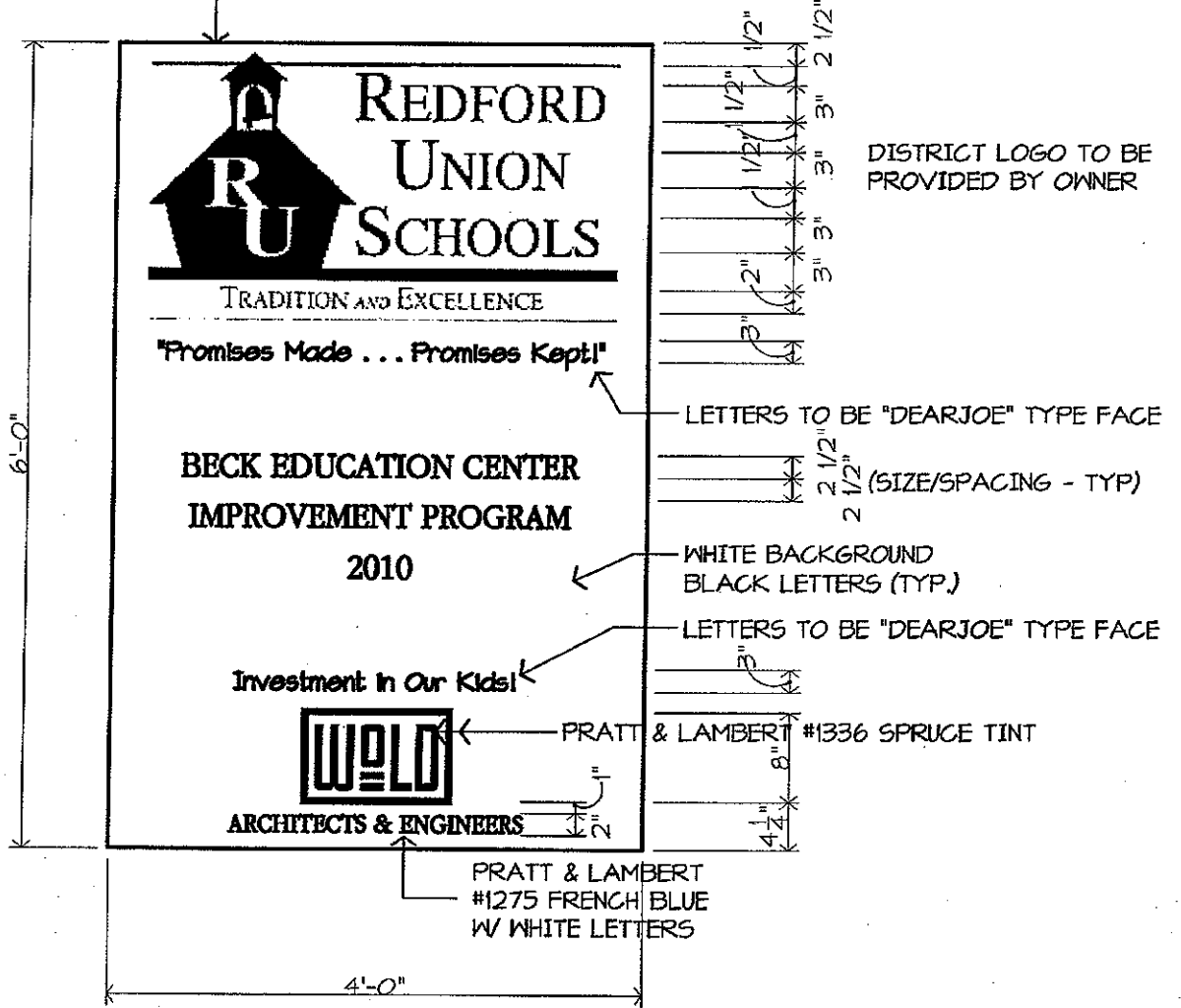

NOTE: ALL LETTERS TO BE ADOBE GARAMOND UNLESS OTHERWISE NOTED

SUBJECT: BECK EDUCATION CENTER IMPROVEMENTS

DATE: 5/4/10

COMMISSION NO: 094023

REVISIONS

REV. DATE

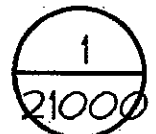

DETAIL OF CONSTRUCTION



MINNESOTA
ILLINOIS
MICHIGAN
COLORADO

MICHIGAN OFFICE
WOLD ARCHITECTS AND ENGINEERS
202 E. THIRD STREET, SUITE 200
ROYAL OAK, MICHIGAN 48067
TEL: 248.284.0611
FAX: 248.284.0615

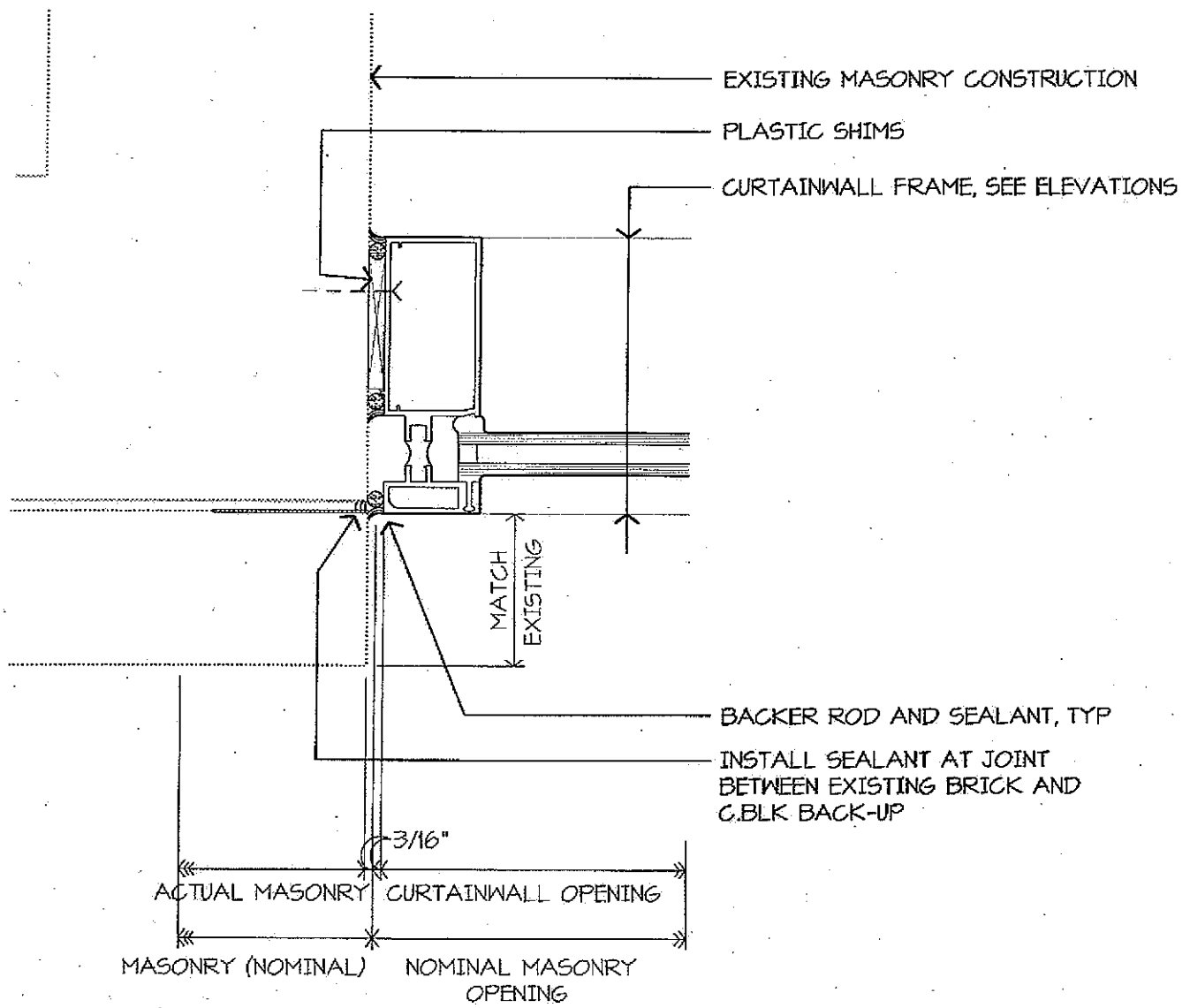

1 JAMB DETAIL
3" = 1'-0"

SUBJECT: REDFORD UNION BECK ELEMENTARY RENOVATIONS

DATE: 5/6/10

COMMISSION NO: 094023

REVISIONS

REV. DATE

31001

DETAIL OF CONSTRUCTION



MINNESOTA
ILLINOIS
MICHIGAN
COLORADO

MICHIGAN OFFICE
WOLD ARCHITECTS AND ENGINEERS
202 E. THIRD STREET, SUITE 200
ROYAL OAK, MICHIGAN 48067
TEL: 248.284.0611
FAX: 248.284.0615

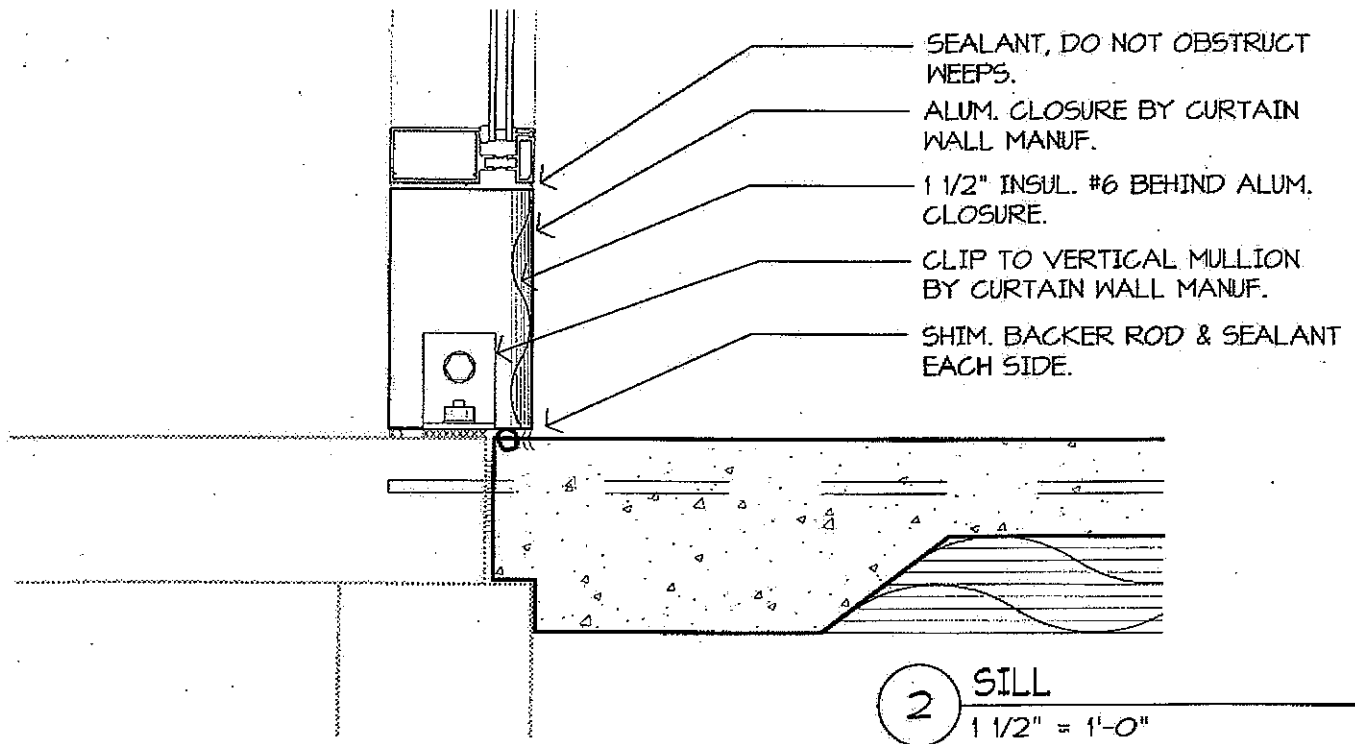
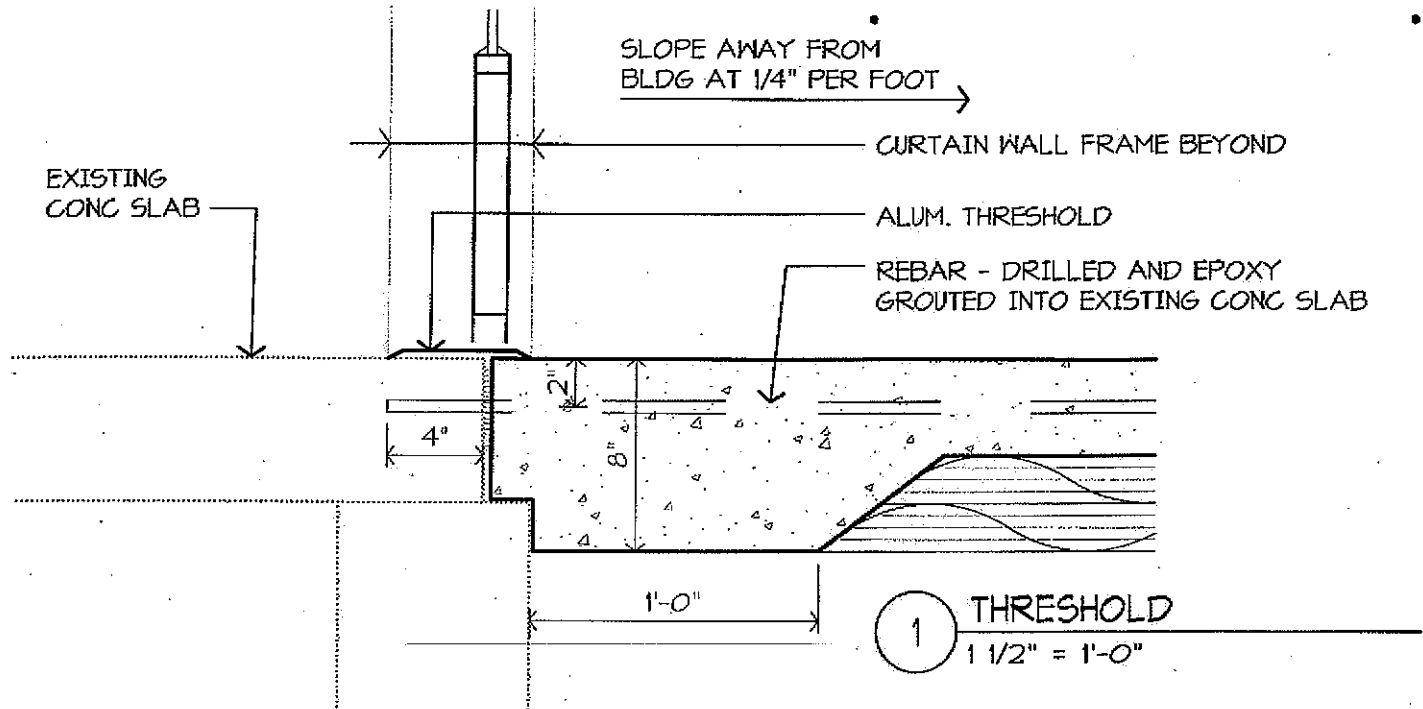

SUBJECT: REDFORD UNION BECK ELEMENTARY RENOVATIONS

DATE: 5/6/10

COMMISSION NO: 094023

REVISIONS

REV. DATE

31002

DETAIL OF CONSTRUCTION



MINNESOTA
ILLINOIS
MICHIGAN
COLORADO

MICHIGAN OFFICE
WOLD ARCHITECTS AND ENGINEERS
202 E. THIRD STREET, SUITE 200
ROYAL OAK, MICHIGAN 48067
TEL: 248.284.0611
FAX: 248.284.0615

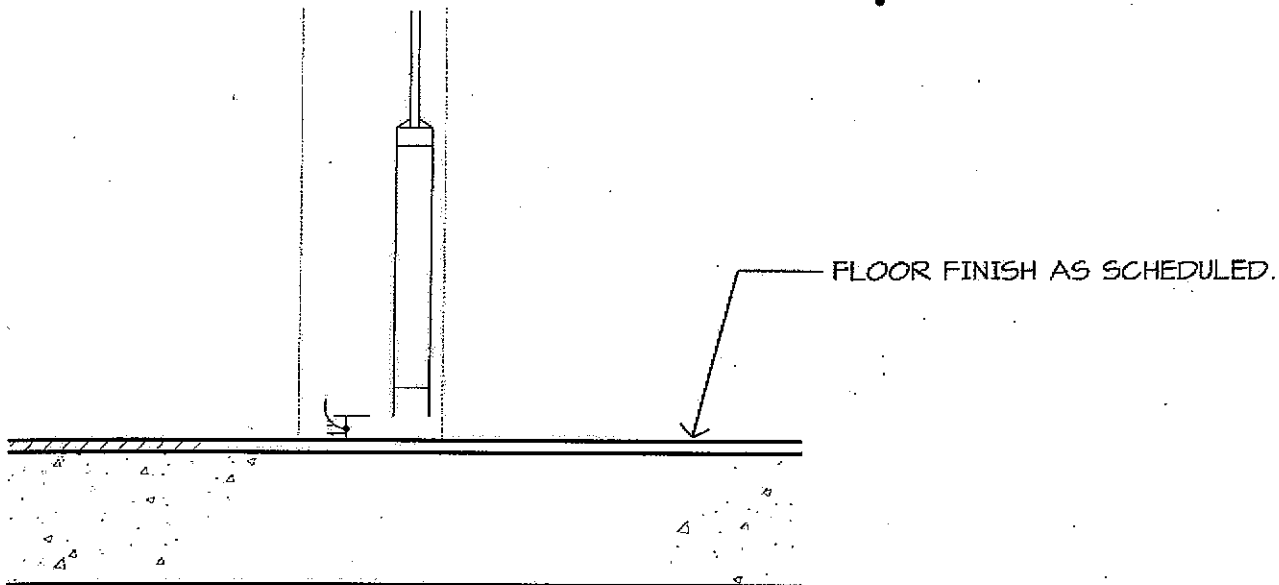

1 INTERIOR ALUM. DOOR UNDERCUT
1 1/2" = 1'-0"

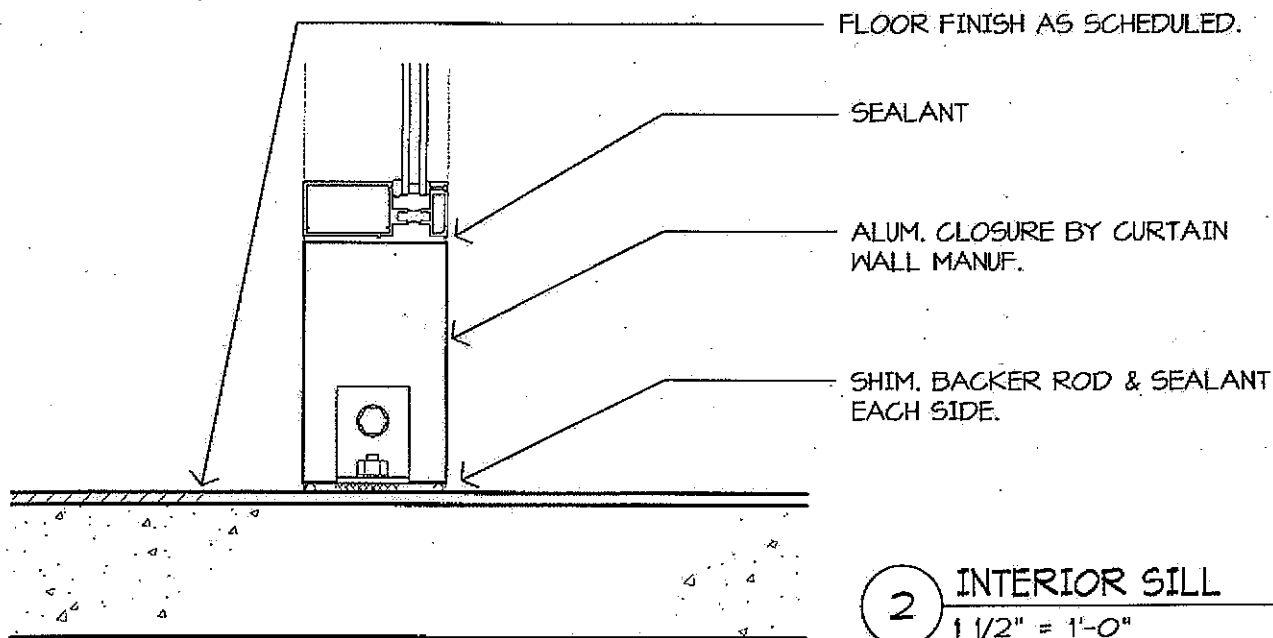

2 INTERIOR SILL
1 1/2" = 1'-0"

SUBJECT: REDFORD UNION BECK ELEMENTARY RENOVATIONS

DATE: 5/6/10

COMMISSION NO: 094023

REVISIONS



REV. DATE

31003

DETAIL OF CONSTRUCTION



MINNESOTA
ILLINOIS
MICHIGAN
COLORADO

MICHIGAN OFFICE
WOLD ARCHITECTS AND ENGINEERS
202 E. THIRD STREET, SUITE 200
ROYAL OAK, MICHIGAN 48067
TEL: 248.284.0611
FAX: 248.284.0615

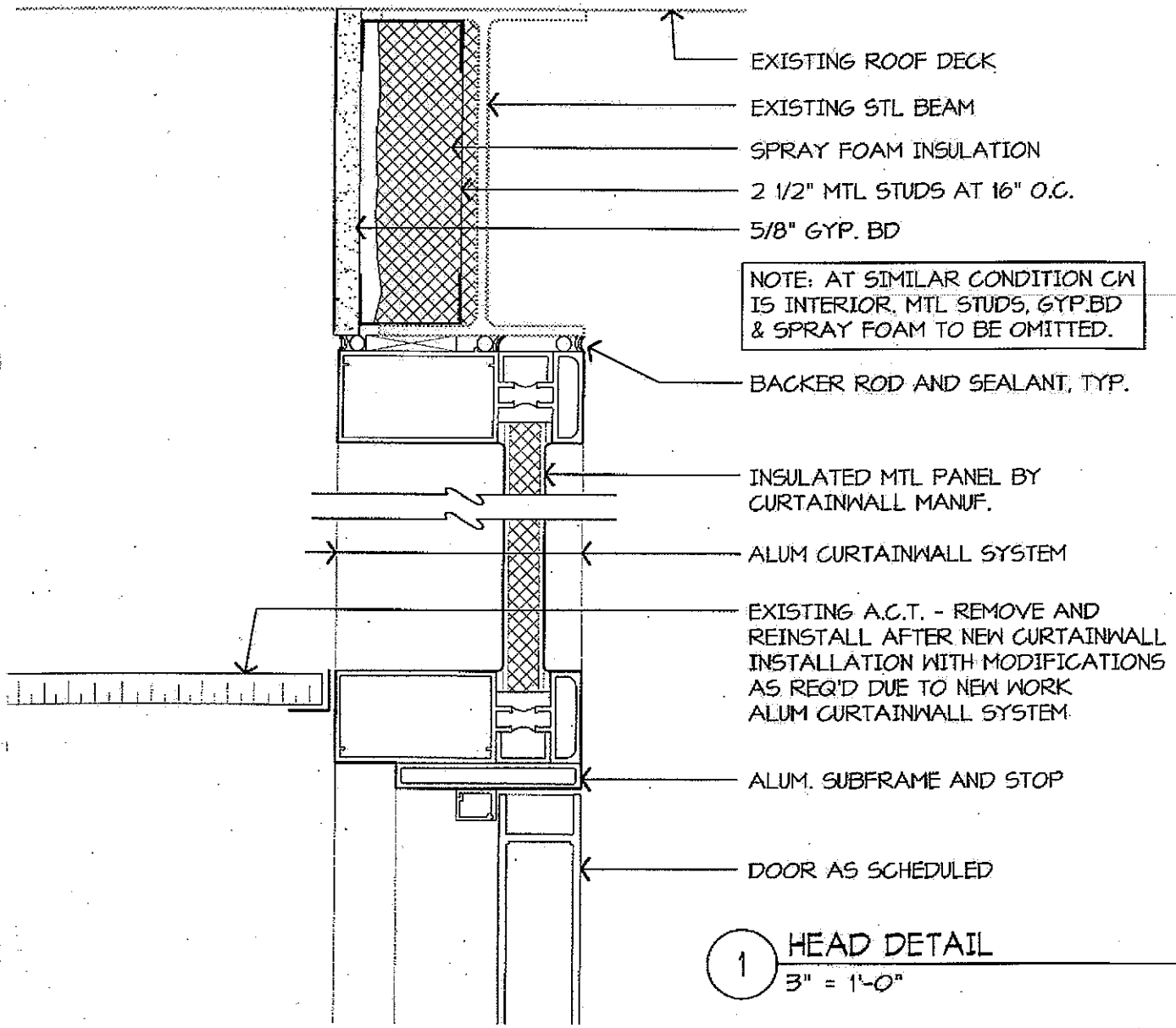

NOTE: AT SIMILAR CONDITION CW IS INTERIOR. MTL STUDS, GYP.BD & SPRAY FOAM TO BE OMITTED.

① HEAD DETAIL
3" = 1'-0"

SUBJECT: REDFORD UNION BECK ELEMENTARY RENOVATIONS

DATE: 5/6/10

COMMISSION NO: 094023

REVISIONS

REV. DATE

31004

DETAIL OF CONSTRUCTION



MINNESOTA
ILLINOIS
MICHIGAN
COLORADO

MICHIGAN OFFICE
WOLD ARCHITECTS AND ENGINEERS
202 E. THIRD STREET, SUITE 200
ROYAL OAK, MICHIGAN 48067
TEL: 248.284.0611
FAX: 248.284.0615

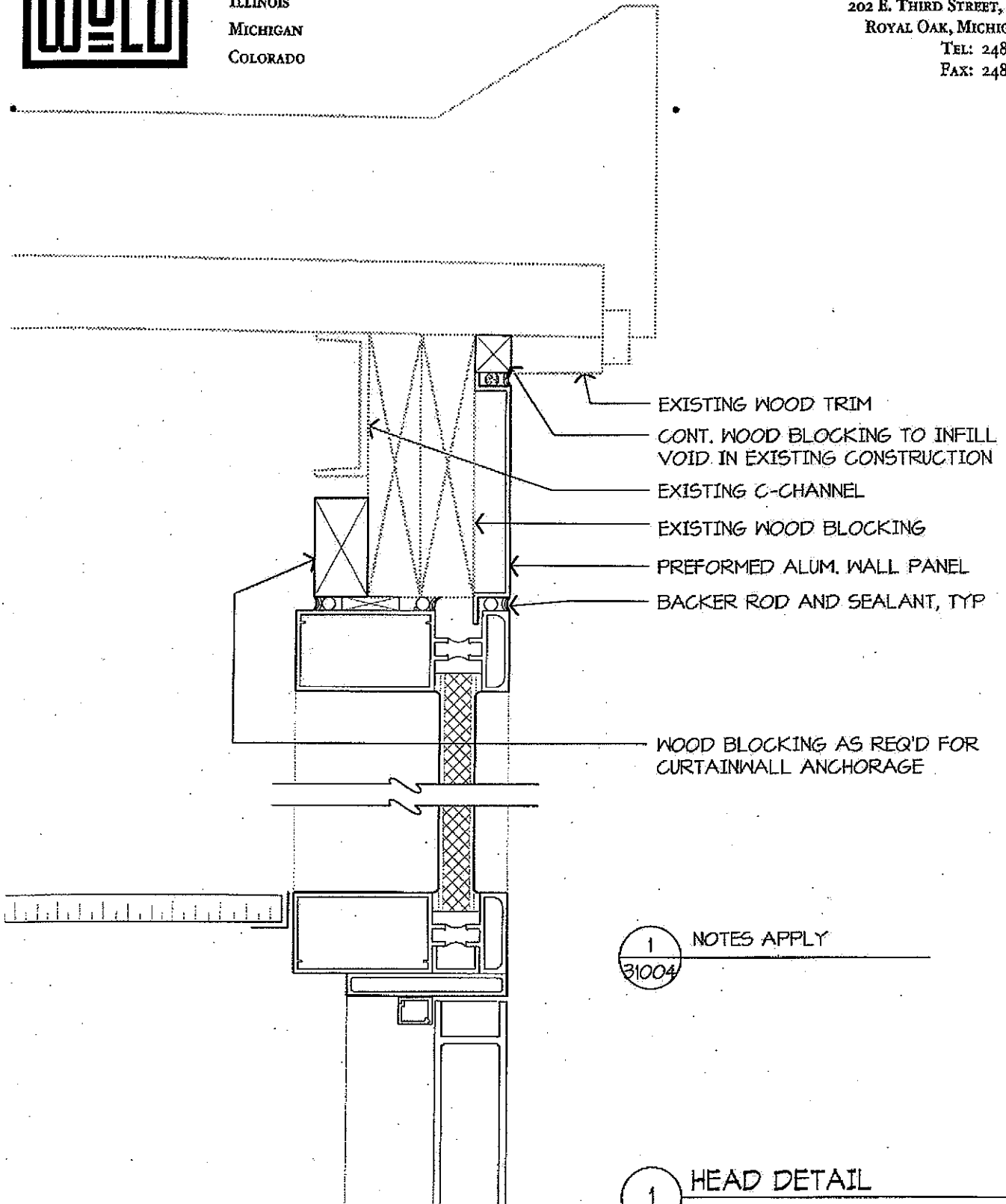

- EXISTING WOOD TRIM
- CONT. WOOD BLOCKING TO INFILL VOID IN EXISTING CONSTRUCTION
- EXISTING C-CHANNEL
- EXISTING WOOD BLOCKING
- PREFORMED ALUM. WALL PANEL
- BACKER ROD AND SEALANT, TYP
- WOOD BLOCKING AS REQ'D FOR CURTAINWALL ANCHORAGE

1 NOTES APPLY
31004

1 HEAD DETAIL
3" = 1'-0"

SUBJECT: REDFORD UNION BECK ELEMENTARY RENOVATIONS

DATE: 5/6/10

COMMISSION NO: 094023

REVISIONS \triangle

REV. DATE

31005

DETAIL OF CONSTRUCTION



MINNESOTA
ILLINOIS
MICHIGAN
COLORADO

MICHIGAN OFFICE
WOLD ARCHITECTS AND ENGINEERS
202 E. THIRD STREET, SUITE 200
ROYAL OAK, MICHIGAN 48067
TEL: 248.284.0611
FAX: 248.284.0615

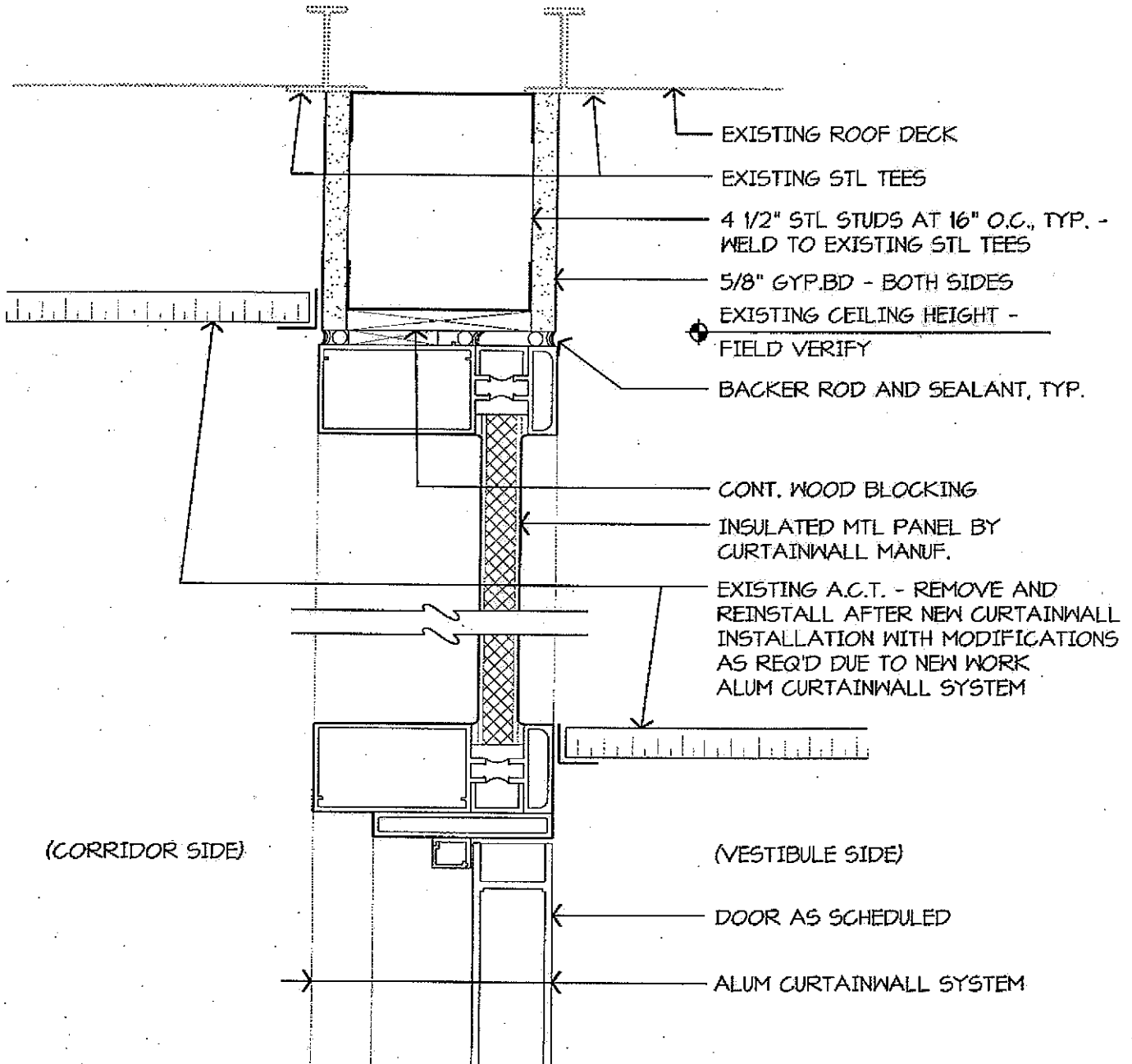

① HEAD DETAIL
3" = 1'-0"

SUBJECT: REDFORD UNION BECK ELEMENTARY RENOVATIONS

DATE: 5/6/10

COMMISSION NO: 094023

REVISIONS

REV. DATE

31006

DETAIL OF CONSTRUCTION



MINNESOTA
ILLINOIS
MICHIGAN
COLORADO

MICHIGAN OFFICE
WOLD ARCHITECTS AND ENGINEERS
202 E. THIRD STREET, SUITE 200
ROYAL OAK, MICHIGAN 48067
TEL: 248.284.0611
FAX: 248.284.0615

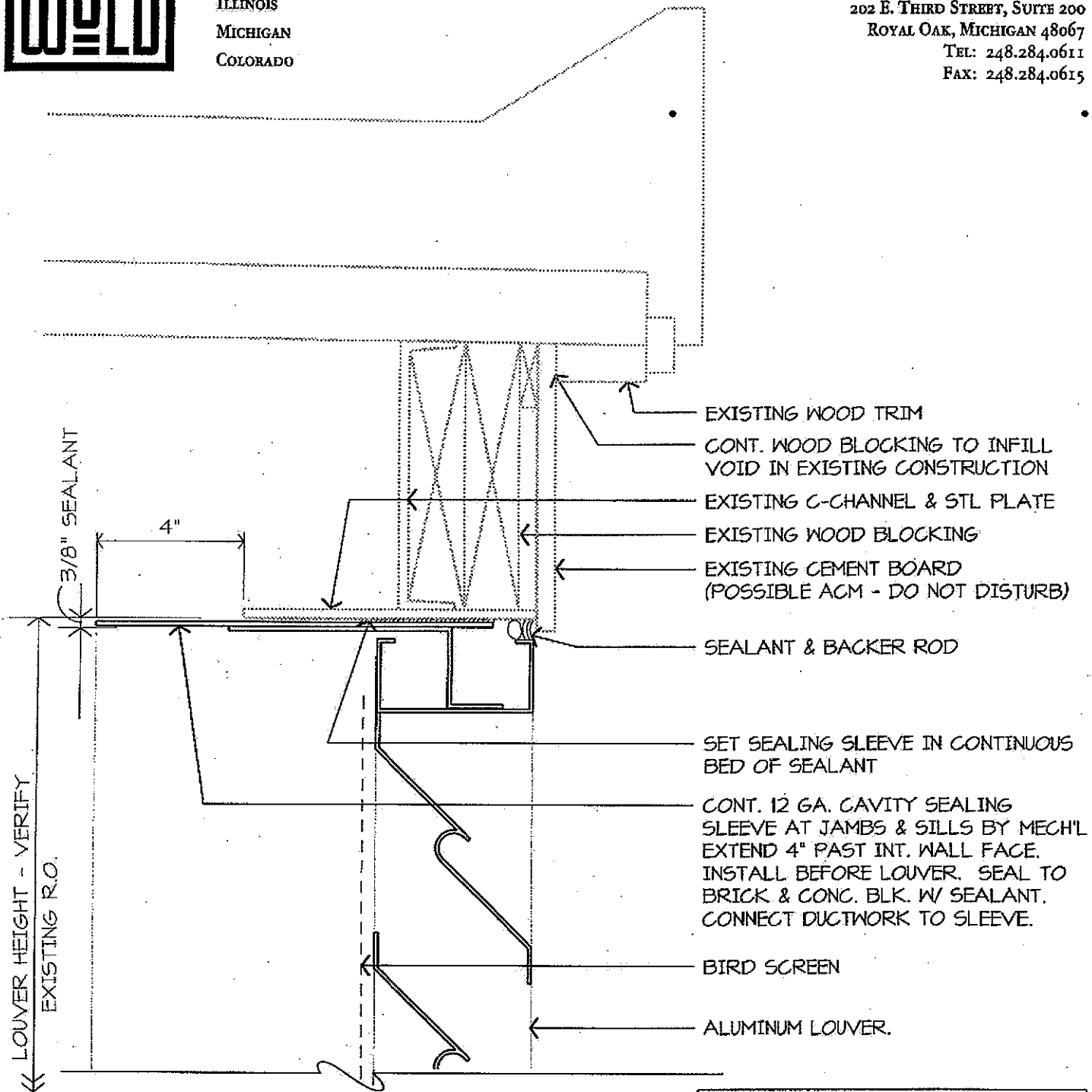

NOTE: EXISTING WINDOW FRAMING GLAZING AND LOUVER IN EXISTING ROUGH OPENING TO BE DEMO'D

1 LOUVER HEAD DETAIL
3" = 1'-0"

SUBJECT: REDFORD UNION BECK ELEMENTARY RENOVATIONS

DATE: 5/6/10

COMMISSION NO: 094023

REVISIONS

REV. DATE

31007

DETAIL OF CONSTRUCTION



MINNESOTA
ILLINOIS
MICHIGAN
COLORADO

MICHIGAN OFFICE
WOLD ARCHITECTS AND ENGINEERS
202 E. THIRD STREET, SUITE 200
ROYAL OAK, MICHIGAN 48067
TEL: 248.284.0611
FAX: 248.284.0615

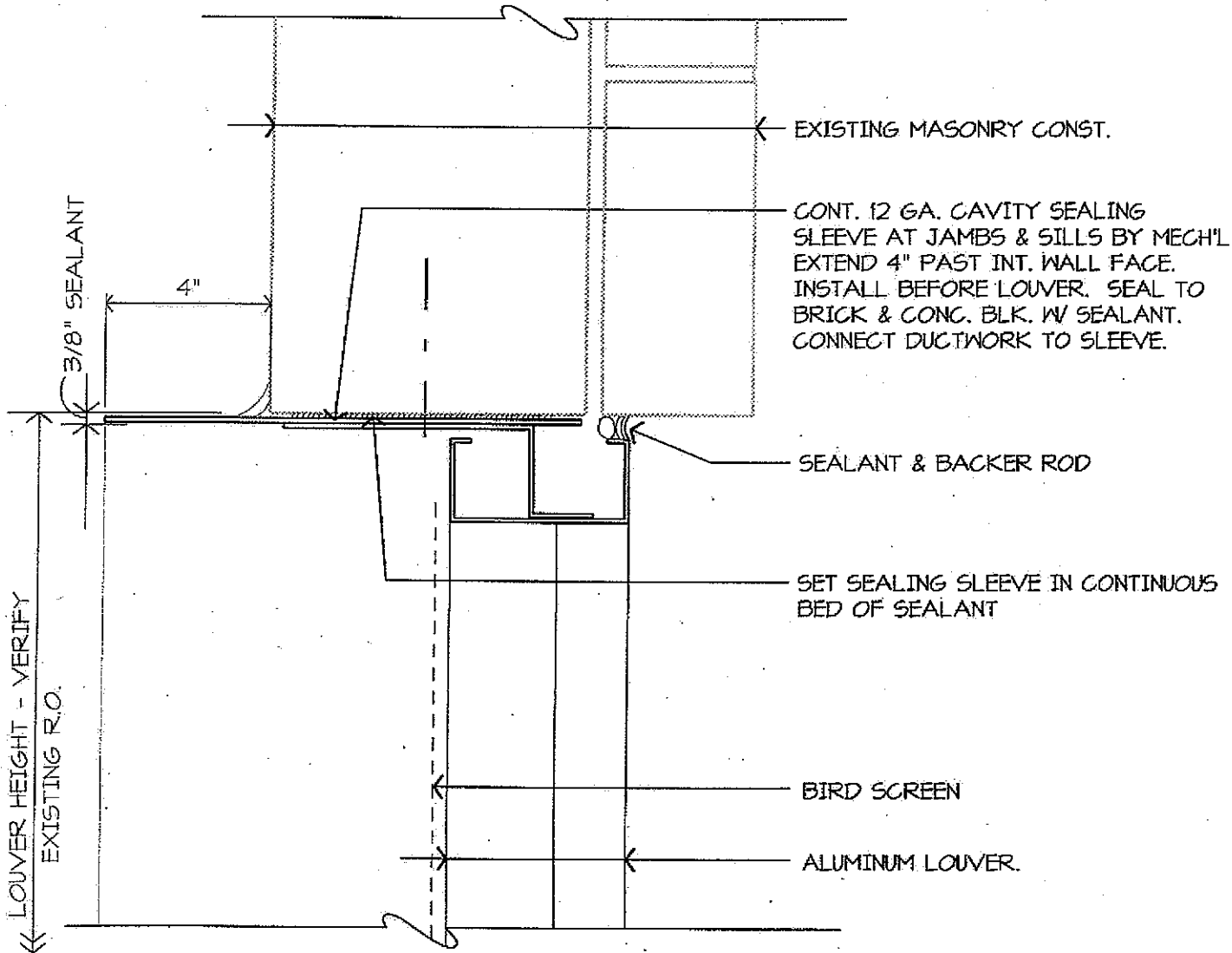

NOTE :EXISTING WINDOW FRAMING
GLAZING AND LOUVER IN EXISTING
ROUGH OPENING TO BE DEMO'D

① LOUVER JAMB DETAIL
3" = 1'-0"

SUBJECT: REDFORD UNION BECK ELEMENTARY RENOVATIONS

DATE: 5/6/10

COMMISSION NO: 094023

REVISIONS

REV. DATE

31008

DETAIL OF CONSTRUCTION



MINNESOTA
ILLINOIS
MICHIGAN
COLORADO

MICHIGAN OFFICE
WOLD ARCHITECTS AND ENGINEERS
202 E. THIRD STREET, SUITE 200
ROYAL OAK, MICHIGAN 48067
TEL: 248.284.0611
FAX: 248.284.0615

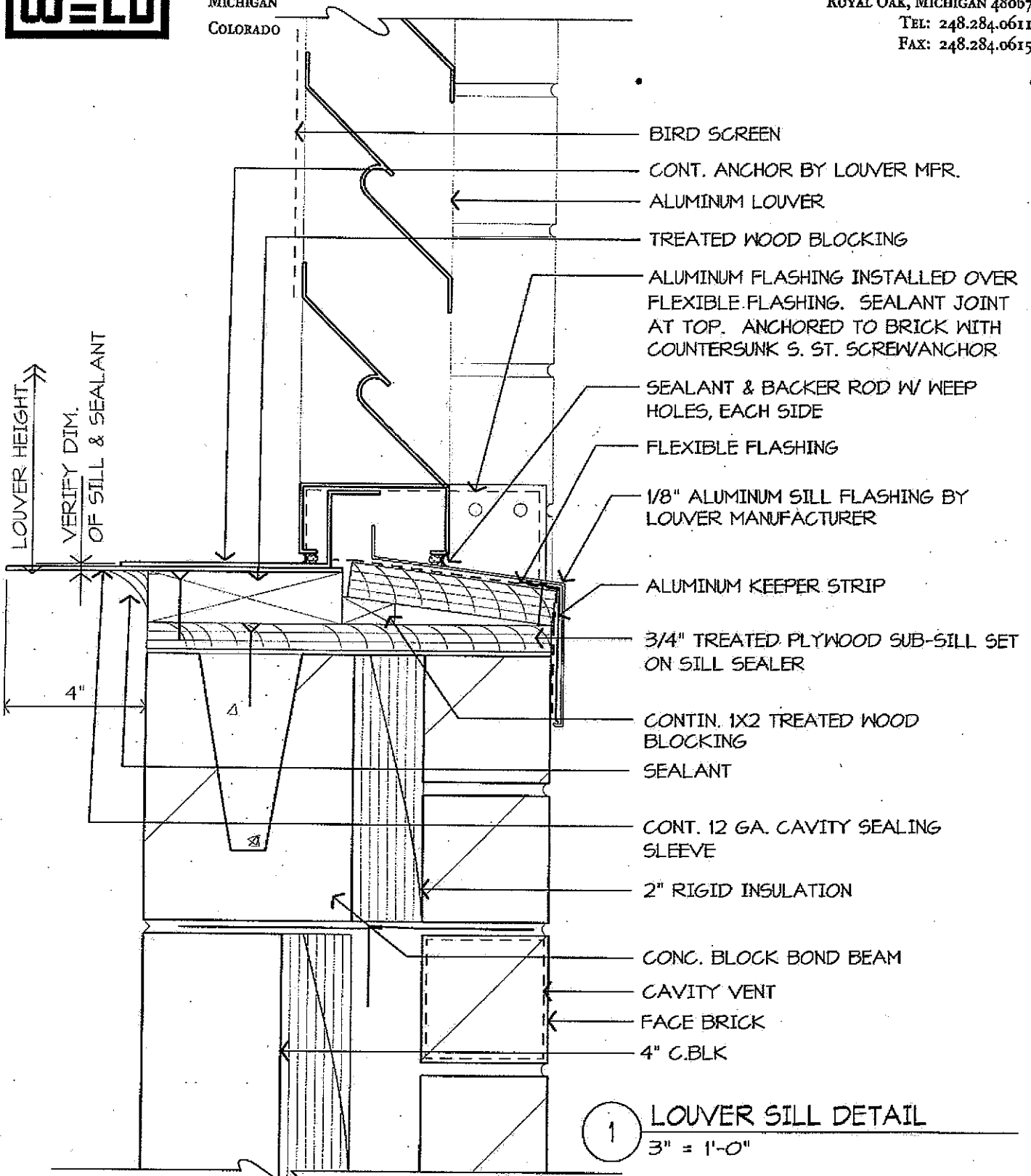

1 LOUVER SILL DETAIL
3" = 1'-0"

SUBJECT: REDFORD UNION BECK ELEMENTARY RENOVATIONS

DATE: 5/6/10

COMMISSION NO: 094023

REVISIONS

REV. DATE

31009

DETAIL OF CONSTRUCTION



MINNESOTA
ILLINOIS
MICHIGAN
COLORADO

MICHIGAN OFFICE
WOLD ARCHITECTS AND ENGINEERS
202 E. THIRD STREET, SUITE 200
ROYAL OAK, MICHIGAN 48067
TEL: 248.284.0611
FAX: 248.284.0615

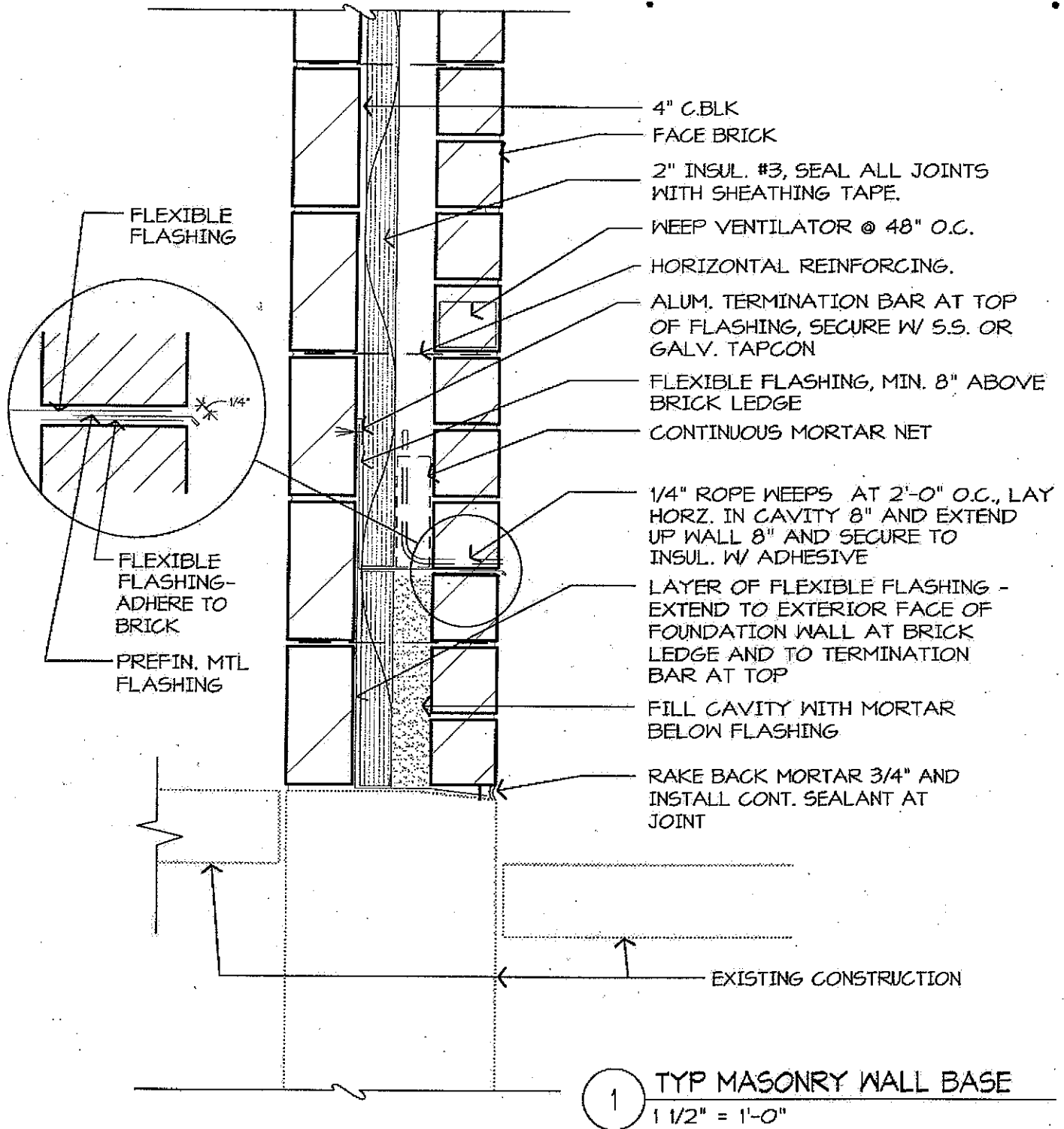

SUBJECT: REDFORD UNION BECK ELEMENTARY RENOVATIONS

DATE: 5/6/10

COMMISSION NO: 094023

REVISIONS

REV. DATE

31010

DETAIL OF CONSTRUCTION



MINNESOTA
ILLINOIS
MICHIGAN
COLORADO

MICHIGAN OFFICE
WOLD ARCHITECTS AND ENGINEERS
202 E. THIRD STREET, SUITE 200
ROYAL OAK, MICHIGAN 48067
TEL: 248.284.0611
FAX: 248.284.0615

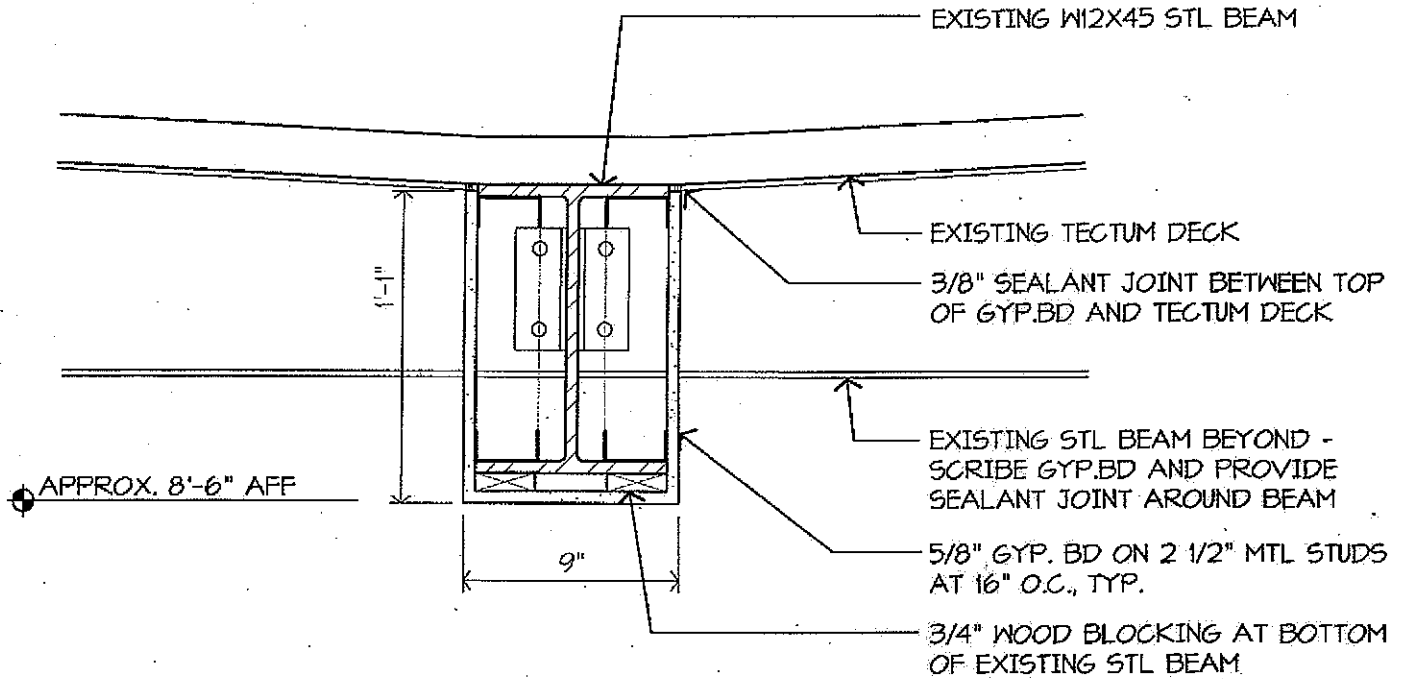

1

GYP. BOARD SOFFIT
1 1/2" = 1'-0"

SUBJECT: REDFORD UNION BECK ELEMENTARY RENOVATIONS

DATE: 5/6/10

COMMISSION NO: 094023

REVISIONS

REV. DATE

43001

DETAIL OF CONSTRUCTION



MINNESOTA
ILLINOIS
MICHIGAN
COLORADO

MICHIGAN OFFICE
WOLD ARCHITECTS AND ENGINEERS
202 E. THIRD STREET, SUITE 200
ROYAL OAK, MICHIGAN 48067
TEL: 248.284.0611
FAX: 248.284.0615

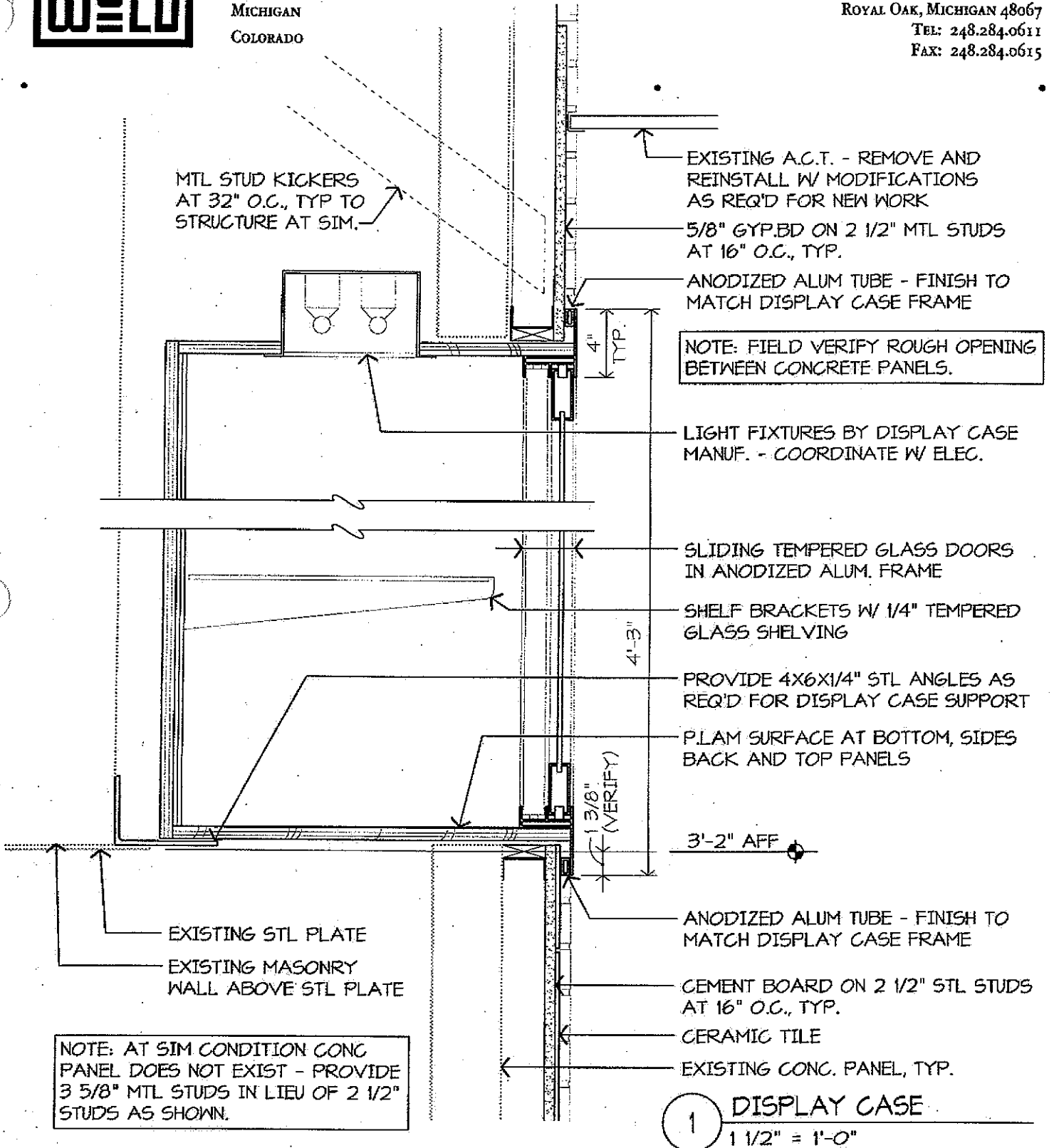

SUBJECT: REDFORD UNION BECK ELEMENTARY RENOVATIONS

DATE: 5/6/10

COMMISSION NO: 094023

REVISIONS

REV. DATE

43002

DETAIL OF CONSTRUCTION



MINNESOTA
ILLINOIS
MICHIGAN
COLORADO

MICHIGAN OFFICE
WOLD ARCHITECTS AND ENGINEERS
202 E. THIRD STREET, SUITE 200
ROYAL OAK, MICHIGAN 48067
TEL: 248.284.0611
FAX: 248.284.0615

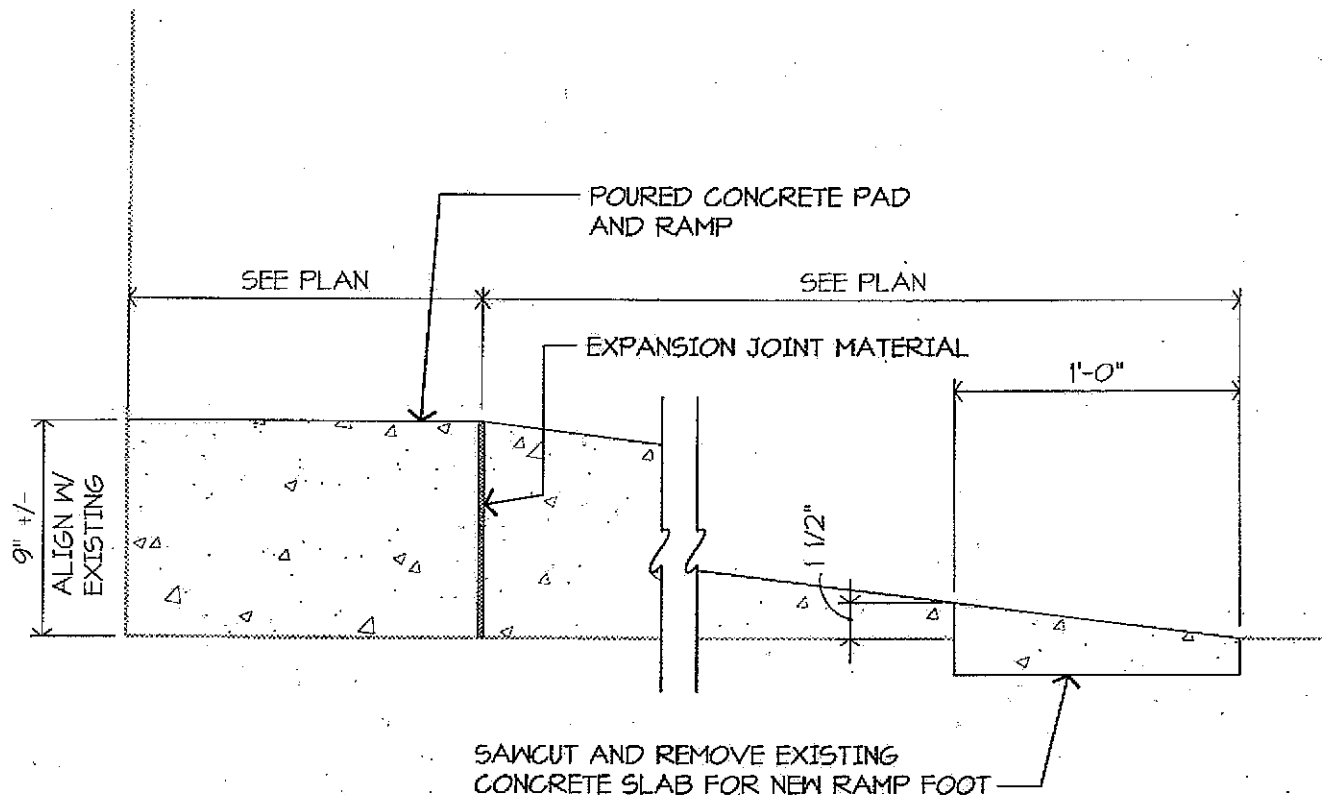

1 CONCRETE PAD/RAMP
1 1/2" = 1'-0"

SUBJECT: REDFORD UNION BECK ELEMENTARY RENOVATIONS

DATE: 5/6/10

COMMISSION NO: 094023

REVISIONS

REV. DATE

43003